

OLD STONE COMBINED TEST

Sunday, June 14, 2009

2920 Minton Rd, Hamilton, OH 45013
(Minton Rd is 9 miles south of Oxford on US 27)

MSEDA Sanctioning Pending

Judge: Nancy Nicholson (Dressage)
Judge: Trish Hammer (Dressage & Stadium)
TD:

Organizer: Julie Bath (513) 868-3042

Combined Test Divisions

Fees: \$55.00/division \$95/2 divisions (same horse/rider combination). *Entry fee less \$15 administrative fee if withdrawal is received with doctor or veterinarian written certification. Otherwise, no refunds after closing date. All classes open to any age rider. The same horse may compete with different riders.*

Trophy and ribbons through sixth place in each division.

Greener than Grass Division

Dressage USDF Intro A
Stadium: Fences 18" max – No time limit

Pre-Starter Division

Dressage USDF Intro B
Stadium: Fences 2'0" max – No time limit

Starter Division

Dressage USDF Intro B
Stadium: Fences 2'3" max at 250m/min.

Beginner Novice Division

Dressage USEF 2006 BN Test B
Stadium: Fences 2'7"max at 275m/min

Novice Division

Dressage USEF 2006 Novice Test A
Stadium: Fences 2'11"max at 300m/min

Training Division

Dressage USEF 2006 Training Test A
Stadium: Fences 3'3"max at 325 m/min

Closing Date: June 6, 2009

Old Stone Riding Center is not responsible for accident or loss.

Notes:

- Proper headgear, per USEA rule, required. Certified helmet and medical armbands required for jumping.
- Limited stall space available. Call for information. Fee is \$35 per night.
- Food on the grounds.

Rider's Name _____ Horse's Name _____

Address _____

Cost: \$55.00 per division, \$95 for two division if same horse and rider

Stall Fee: \$35.00

Division/Class	Fee

Mail to:

Old Stone Riding Center
2920 Minton Rd.
Hamilton, OH 45056

Total Entry _____

Office & EMT Fee/rider \$10.00

Stabling Fee (\$35) _____

TOTAL _____

Please include the following:

- Proof of negative Coggins with entry.
- Email or Phone # to use for ride times (please note which preferred).
- Make checks payable to Old Stone Riding Center
- Completed and signed entry form

I understand that this is a high-risk sport and I am participating at my own risk. I agree to hold the Old Stone Riding Center, owners, employees, and volunteer workers harmless for any claim for bodily injury or property damage that may occur as a result of my riding, boarding, spectating, or participating in this show. This agreement shall be interpreted under the laws of the State of Ohio.

Print Name (Parent/Guardian must sign if rider is under 18) _____

Signature _____

Date _____

Phone: Home/Cell _____

Email _____

OLD STONE RIDING CENTER

2920 Minton Road, Hamilton, Ohio 45013

www.OldStoneRidingCenter.com

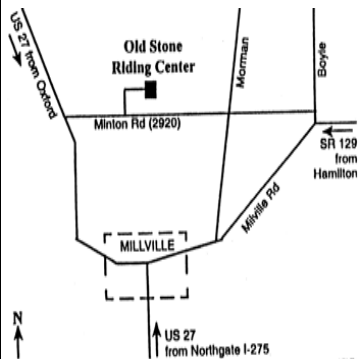

Minton Road is at the top of the hill on US 27, one mile north of Millville.
US 27 from I-275 avoids Hamilton traffic.

**GO TO OUR WEB
SITE FOR UP-TO-
DATE SHOW, CAMP
AND CLINIC
INFORMATION!**



**OLD STONE
RIDING CENTER**

Old Stone Combined Test

Sunday, June 14, 2009

MSEDA Sanctioning Pending

Judge: Nancy Nicholson (Dressage)

Judge: Trish Hammer (Dressage & Stadium)

TD:

***Organizer: Julie Bath,
(513) 868-3042***

Go to our web site
WWW.OLDSTONERIDINGCENTER.COM
to check out current or updated SHOW and CLINIC dates!